

# User Guide

---

## Personal Digital Assistant (PDA)

# Frey Gider



**Version 1.0**

---

*April/ 30/ 2017*

## Table of Contents

---

---

Charpt 1.	Revision History .....	4
Charpt 2.	About this manual.....	5
Charpt 3.	Overview .....	6
3.1.	Specification .....	6
3.2.	Package.....	8
3.3.	Getting Start.....	8
3.3.1.	Front & Site View .....	8
3.3.2.	Back, Top & Bottom View .....	10
3.3.3.	Battery Installation .....	11
3.3.4.	SIM Card/SD card Installation .....	13
3.3.5.	Charging the battery .....	14
3.3.6.	Switch the power on or off .....	15
3.3.7.	Transfer file between Frey Glider and Computer.....	18
Charpt 4.	Installation & Operation .....	22
4.1.	Barcode.....	23
4.1.1.	Scanner Setting .....	23
4.1.2.	Scan Demo.....	26
4.2.	Wireless & Networks.....	27
4.2.1.	Wi-Fi.....	28
4.2.2.	Bluetooth .....	29
4.2.3.	Airplane mode .....	30
4.2.4.	NFC .....	32
4.2.5.	Set Fey Glider as a portable hotspot.....	34
4.2.6.	Sharing Frey Glider internet connect by USB.....	35
4.2.7.	Sharing Frey Glider internet connect by Bluetooth.....	36
4.3.	Backup & Reset .....	36
4.4.	Phone .....	38
4.5.	People .....	38
4.6.	Message .....	40
4.7.	Email.....	42
4.8.	Camera.....	43
4.9.	Calendar.....	46
4.10.	Calculator .....	47
4.11.	File Manager.....	49



4.12.	Widgets/APPS .....	52
Charpt 5.	Appendix .....	53
5.1.	Regulatory .....	53
5.2.	Battery Notes .....	53
5.3.	Storage and safety notice .....	54
5.4.	Product Operation and Storage Notice .....	55
5.5.	Adapter Notes .....	55
5.6.	Support Barcode information .....	56

## Charpt 1.Revision History

---

---

Date	Change Description	Version
2017/04/30	First release	V1.0

## Charpt 2. About this manual

---

Thank you for purchasing the Bitatek product. This manual explains how to install, operate and maintain our product. No part of this publication may be reproduced or used in any form, or by any electrical or mechanical means, such as photocopying, recording, or information storage and retrieval systems, without permission in writing from the manufacturer. The material in this manual is subject to change without notice.

## Charpt 3. Overview

### 3.1. Specification

<b>Processor</b>	Qualcomm APQ8052 Octa core 64-bit Processor
<b>Memory</b>	eMCP, 16GB eMMC Flash ROM plus 2GB LPDDR3 RAM
<b>Display and Touch Panel</b>	5.0", Color FHD Capacitive type 5 points multi-touch touch panel with Gorilla Glass Support finger, glove and stylus
<b>Expansion Slot</b>	One user accessible Micro SD Memory Slot One user accessible SIM slot
<b>External Connector</b>	One user accessible micro SD Memory slot with SDHC compliance and software image upgrade features One user accessible Micro SIM slot Micro USB (B type) support USB 2.0 OTG and USB charge Cradle connector support USB 2.0 and DC power input
<b>Wireless PAN</b>	Bluetooth 4.1 LE Support profile : HID, A2DP, OPP, SPP
<b>Wireless LAN</b>	802.11a/b/g/n/ac Wireless LAN, 2.4GHz and 5GHz Compliant with WEP, WPA and IEEE 802.11i WPA2 Fast roaming under 100ms Enterprise security
<b>Wireless WAN (Option)</b>	<ul style="list-style-type: none"> <li>● Europe: FDD LTE: B1/B3/B5/B7/B8/B20 TDD LTE: B38/B40/B41 WCDMA: B1/B5/B8 GSM: 900/1800</li> <li>● Japan (by request) FDD LTE: B1/B3/B8/B18/B19/B26/B41 WCDMA: B1/B6/B19</li> <li>● North America-V FDD LTE: B4/B13</li> <li>● North America-A (by request) FDD LTE: B2/B4/B12 WCDMA : B2/B4/B5</li> </ul>

	<ul style="list-style-type: none"> <li>● Australia (by request) FDD LTE: B1/B3/B5/B7/B28 WCDMA: B1/B5</li> </ul>
<b>GPS</b>	GPS/GLONASS (Only for WAN model)
<b>NFC</b>	ISO14443-4 (Type A, Type B), ISO15693 Mifare, Felica(ISO/IEC18092)
<b>Power Adapter</b>	100~240Vac, 50/60Hz Input 5V, 2A / 9V, 2A output
<b>Camera</b>	Rear camera: 16M pixels CMOS color camera with autofocus Front camera: 5.0M pixels CMOS color camera LED flash light with torch
<b>Audio and Voice</b>	Dual speaker One receiver and dual noise-cancelling microphones 3.5mm DIA stereo headset jack with MIC. In
<b>Sensor</b>	Accelerometer, Light sensor, Proximity sensor Gyroscope, E-compass
<b>Battery</b>	Replaceable Main Battery : 3.7V, min. 2860mAh Li-Ion battery pack(standard), min. 5720mAh(extended) One rechargeable RTC backup battery One rechargeable backup battery for battery swap
<b>Indicator</b>	One 2- color (green/red) LED for charging LED. Two 2- color (green/red) LED for Logo LED. One 3- color (green/red/blue) LED for information LED. One vibrator for scan or ring in indication Audio tone indication
<b>Scanner</b>	Zebra SE4750 2D scan engine Datalogic Halogen 2(option)
<b>Keypad and Buttons</b>	Front key : standard Android 3 keys(touch key together with touch panel) and one function key. Side Key : Scan key left and right., volume key up and down, power key and function key.
<b>Dimension and Weight</b>	Dimensions: 158 X 77 X 16.9 mm (Estimation) Weight: 250g (Estimation)
<b>Software</b>	Android 6.0
<b>User Environment</b>	Operation Temperature: -20~50°C Storage Temperature: -30~60°C (without Battery) Humidity: 10%~90% non-condensing Sealing: IP67 Standard

	Drop: 1.5m MIL-STD 810G Tumble: 0.5m tumbles for 300 cycles and 600 drops ESD: +/-8KV direct discharge, +/-15KV air discharge
--	---

## 3.2. Package

NO	Description	Q'ty
1	Frey Glider (This Device)	1
2	Battery	1
3	Hand strip	1
4	Quick guide	1
5	USB cable	1
6	Adapter	1

## 3.3. Getting Start

### 3.3.1. Front & Site View

**Front view**



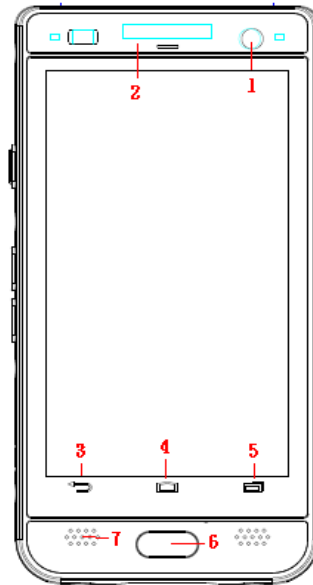

<b>1</b>	<b>Front Camera</b>	<b>5</b>	<b>Menu key</b>
<b>2</b>	<b>Logo LED</b>	<b>6</b>	<b>Scan Button</b>
<b>3</b>	<b>Back key</b>	<b>7</b>	<b>Speaker</b>
<b>4</b>	<b>Home Key</b>		

### Site view

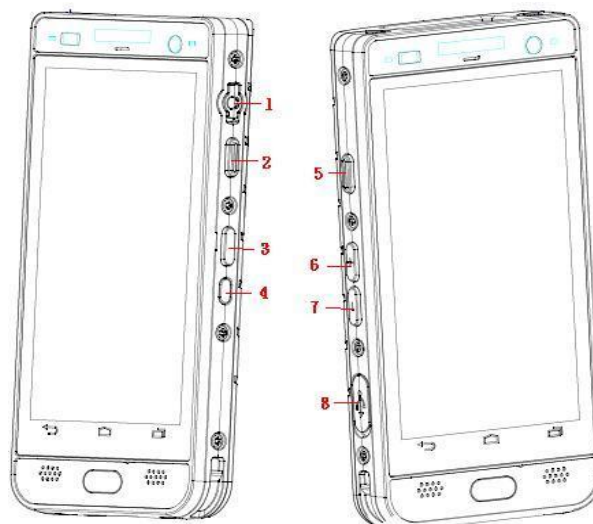

<b>1</b>	<b>Ear Phone Connect</b>	<b>5</b>	<b>Scan Button</b>
<b>2</b>	<b>Scan Button</b>	<b>6</b>	<b>Volume Up</b>
<b>3</b>	<b>Function Button</b>	<b>7</b>	<b>Volume Down</b>
<b>4</b>	<b>Power Button</b>	<b>8</b>	<b>USB Connect</b>

### 3.3.2. Back, Top & Bottom View

#### Back View

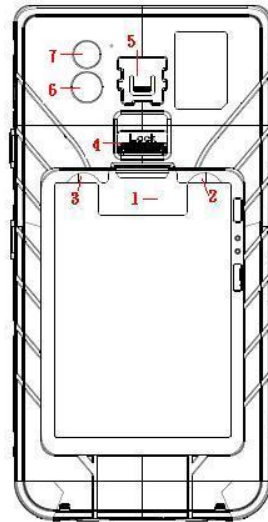

<b>1</b>	<b>Battery Pin</b>	<b>5</b>	<b>Hand Strap Hook</b>
<b>2</b>	<b>SIM Card Slot</b>	<b>6</b>	<b>Back Camera</b>
<b>3</b>	<b>Micro SD Card Slot</b>	<b>7</b>	<b>Flash Led</b>
<b>4</b>	<b>Battery Cover Lock Switch</b>		

#### Top View

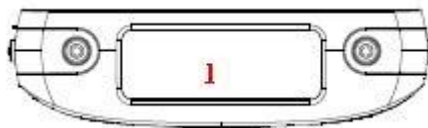

<b>1</b>	<b>Scan Window</b>
----------	--------------------

## Bottom View

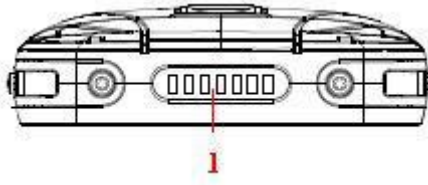

1	Cradle IO Connect
---	-------------------

### 3.3.3. Battery Installation

To install the battery pack, follow the steps below:

1. Move the hand strap from the hand hook, or lose the hand strap from the

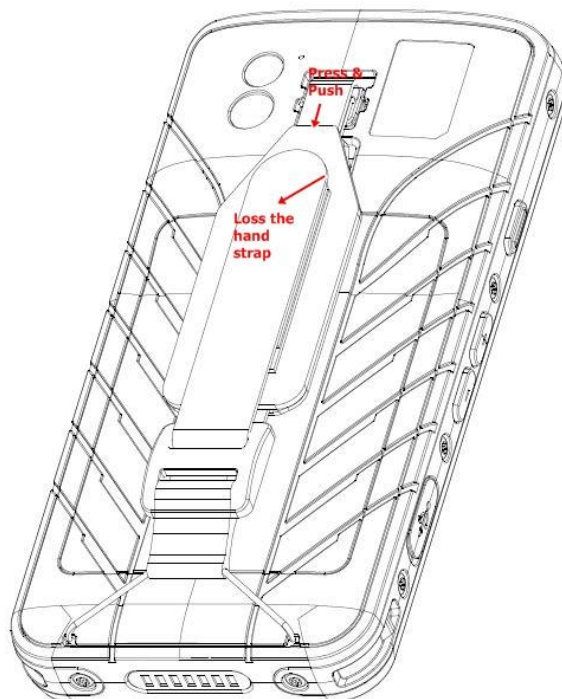

2. Pry and push the battery cover switch to open, and remove Battery Cover from top.

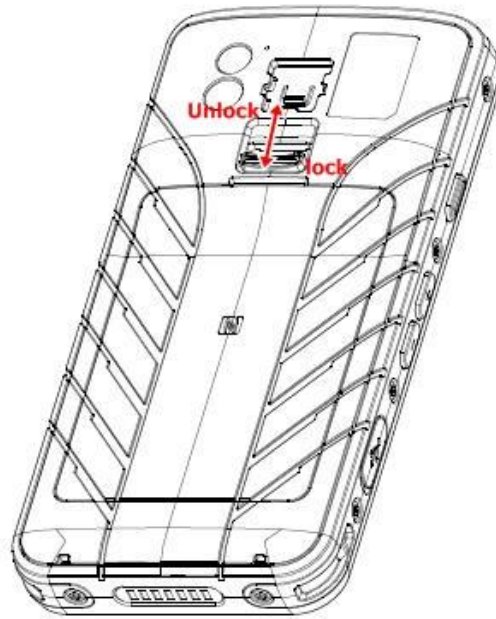

3. Insert the battery pack, and Battery Cover

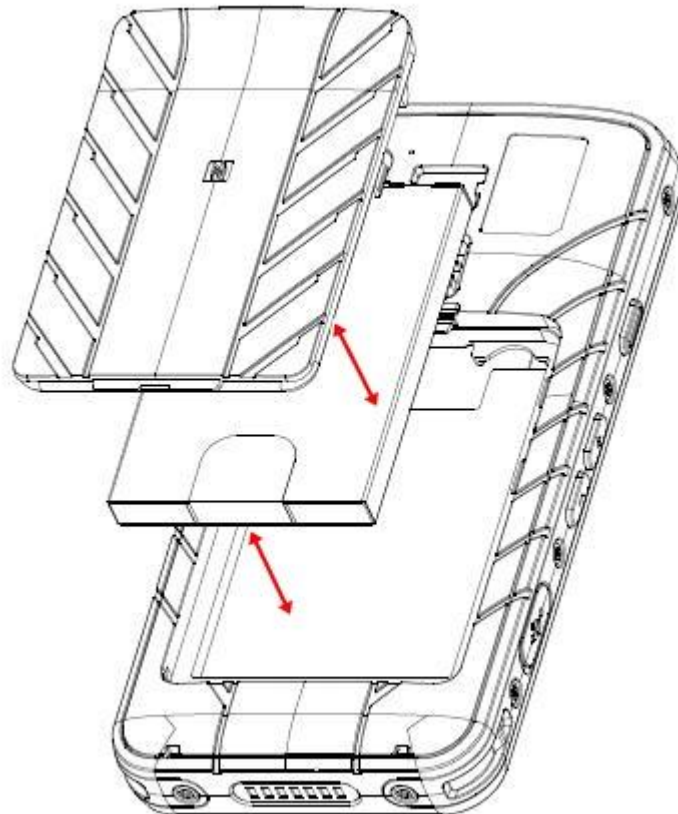

4. Pry and push the battery cover switch to close

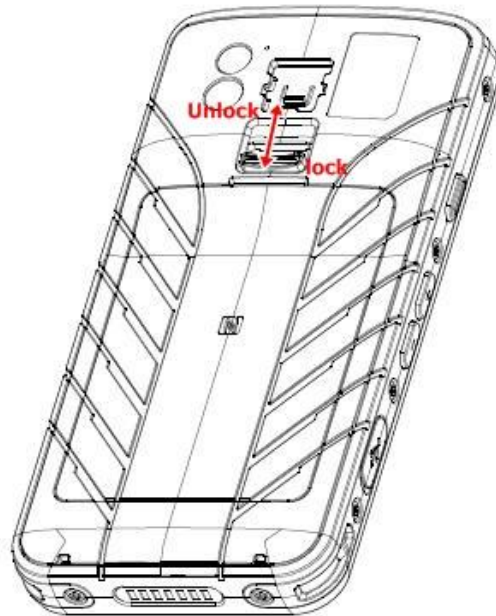

### 3.3.4. SIM Card/SD card Installation

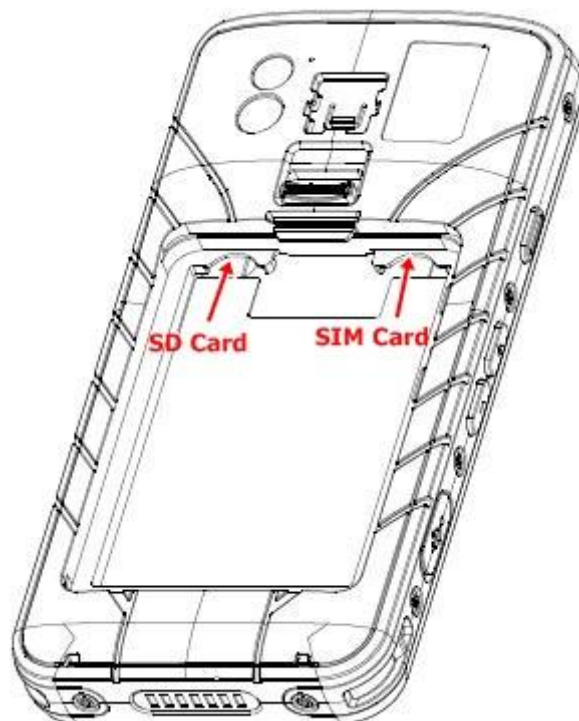

Picture 1

To install the SIM card / Memory card, follow the steps below:

1. Remove the battery cover and battery pack (see **Battery Installation**, step 1 & 2)
2. Insert the SD card to the left slot(please see the picture 1)
3. Insert the SIM card to the right slot(please see the picture 1)
4. Insert the battery pack and battery cover
5. Pry and push the battery cover switch to close

### 3.3.5. Charging the battery

Before you turn on and start using this device, it is recommended that you charge the battery.

If the battery has been discharged for several days, you may need to charge for several minutes before powering it on.

Use only the adapter and the USB cable that came with this device to charge the battery. When the battery power is too low, make sure to use the power adapter or put into the dock to charge, not the USB cable connection with your computer.

**Charge with USB** : (diagrammatical picture)

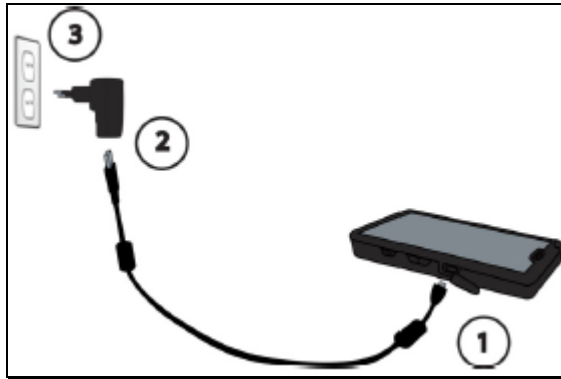

**Charge with Dock :** (diagrammatical picture)

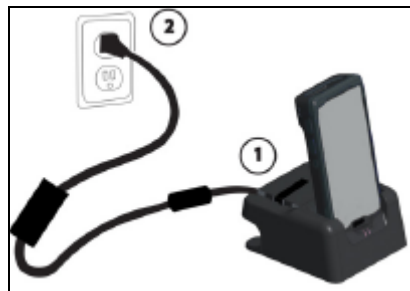

### 3.3.6. Switch the power on or off

#### Switch Power On

Press the **POWER** button until Frey Glider screen start. Like as follow figure 1 and figure 2.

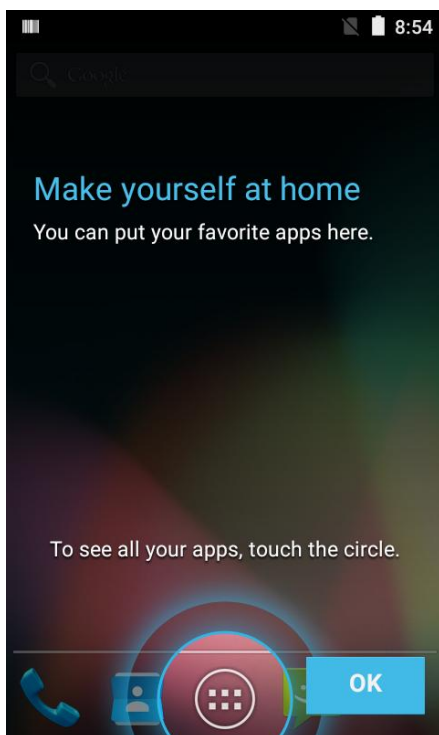

Figure 1



Figure 2

When you turn on Frey Glider for the first time, you can put the app on the desktop, then press **Ok** button









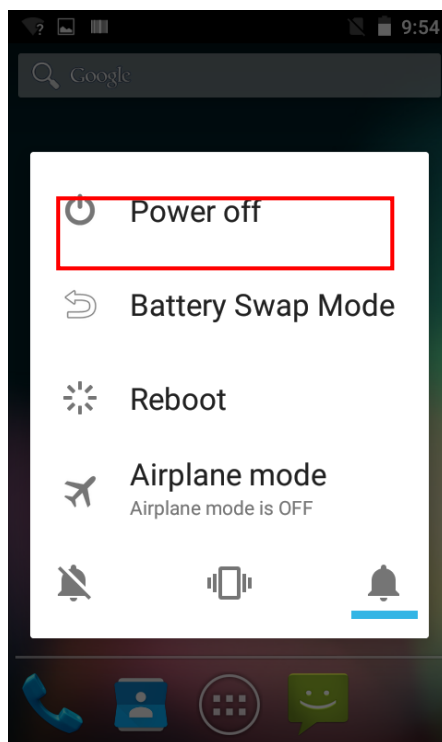

## Switch Power Off

1. If the display is off, press the **POWER** button to turn it back on.
2. Press and hold the **POWER** button for a few seconds.
3. Tap **Power off** on the options menu.



Item	Description
	The system will shut down.
	Enable Airplane mode of settings.
	The system will shut down and reboot system.

	Set the <b>Ringtone &amp; notifications</b> item of volumes Setting to Sound OFF.
	Set the <b>Ringtone &amp; notifications</b> item of volumes Setting to Vibrator.
	The System will shut down and all data will be kept.
	Set the <b>Ringtone &amp; notifications</b> item of volumes Setting to Sound ON.

### 3.3.7. Transfer file between Frey Glider and Computer

You can transfer your file from or to your computer. The OS of host side please use Windows 7 or upper.

- ✧ Connect Frey Glider to your computer. Your computer will recognize it is USB charging.
- ✧ Then slide from top, the system will show as follow picture, then you can select **File transfers** item.

Use USB for	Description
Charging	For charging when you connect with PC host.  If your OS of PC host is Windows XP, only this item be selected and you can't select other items.
File Transfers	For file transfer when you connect with PC host.

	You can find a storage device (ET5001) on your PC host site.
Photo Transfer (PTP)	For file transfer when you connect with PC host. You can find DCIM folder of storage device (ET5001) on your PC host site.
MIDI	For file transfer when you connect with PC host. You can find some folder of storage device (ET5001) on your PC host site.

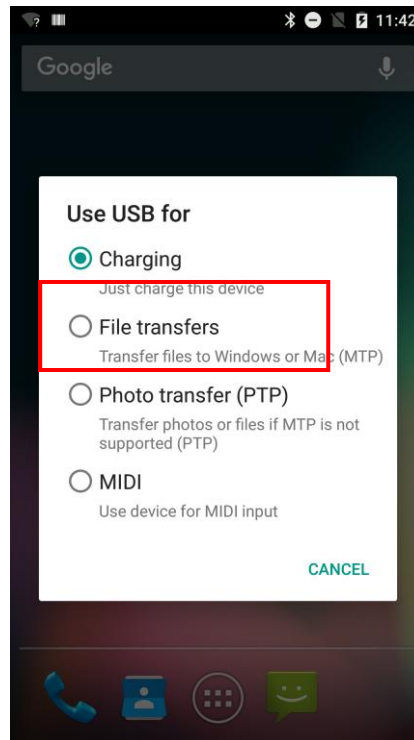

✧ You can see a internal Storage as follow and the file folder.

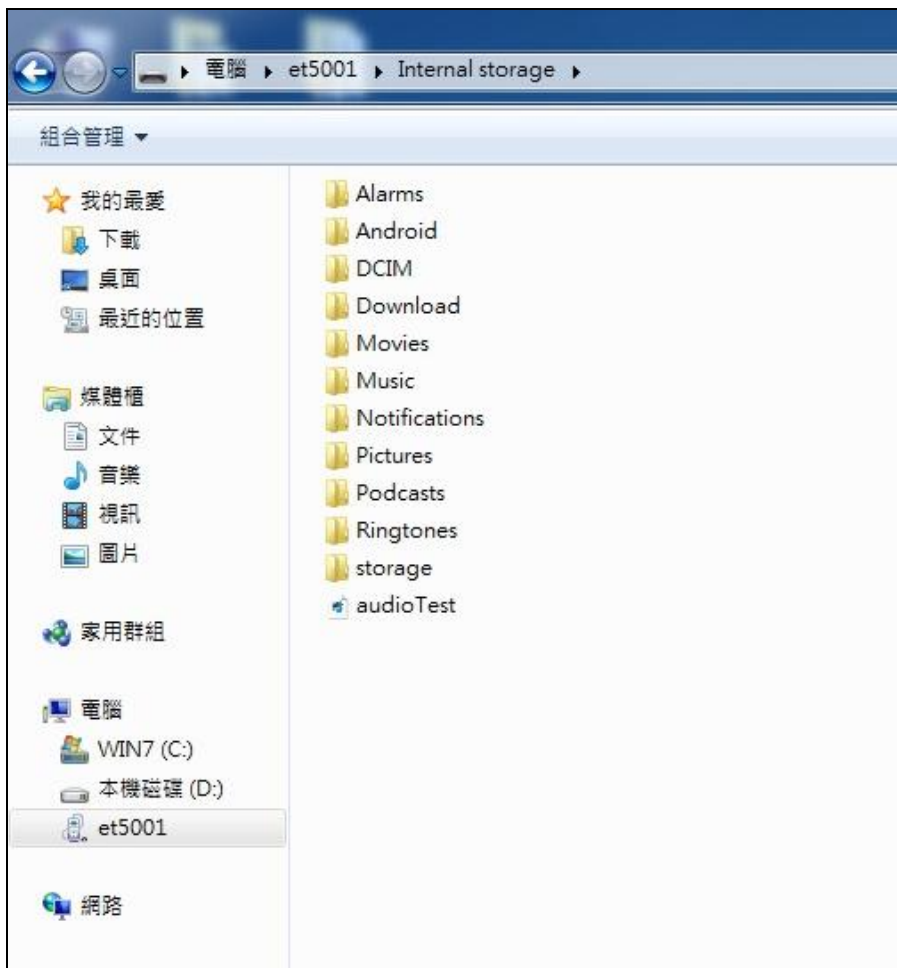

- ✧ You may need to download the Google sync device manager software on your computer. You can set it up to automatically get music, photos, and videos file of Frey Glider to your computer.
- ✧ Please disable check box of **USB debugging** on the **Developer options** item of android Setting when you want transfer file from computer to Frey Glider.

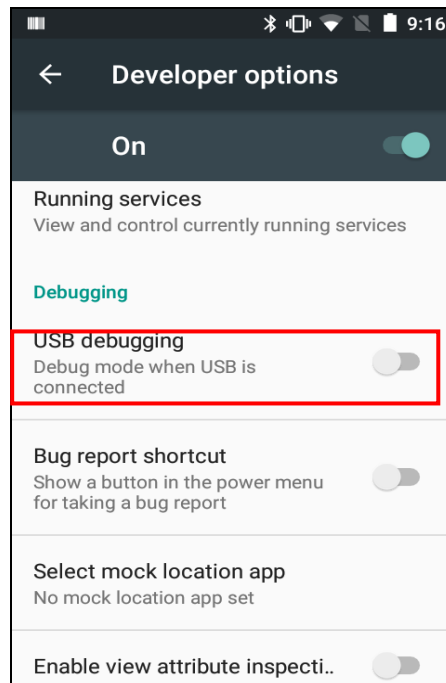

## Charpt 4.Installation & Operation

---

On the home screen when you start up.

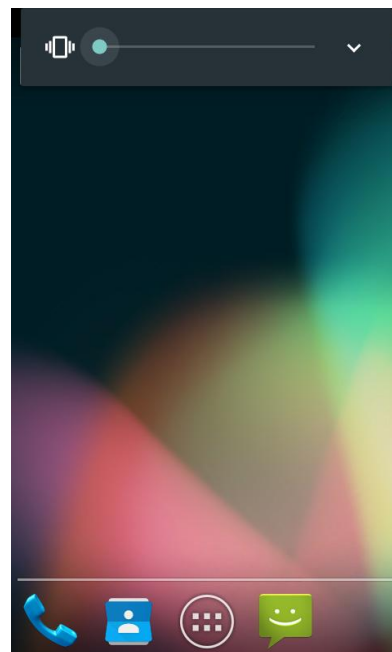
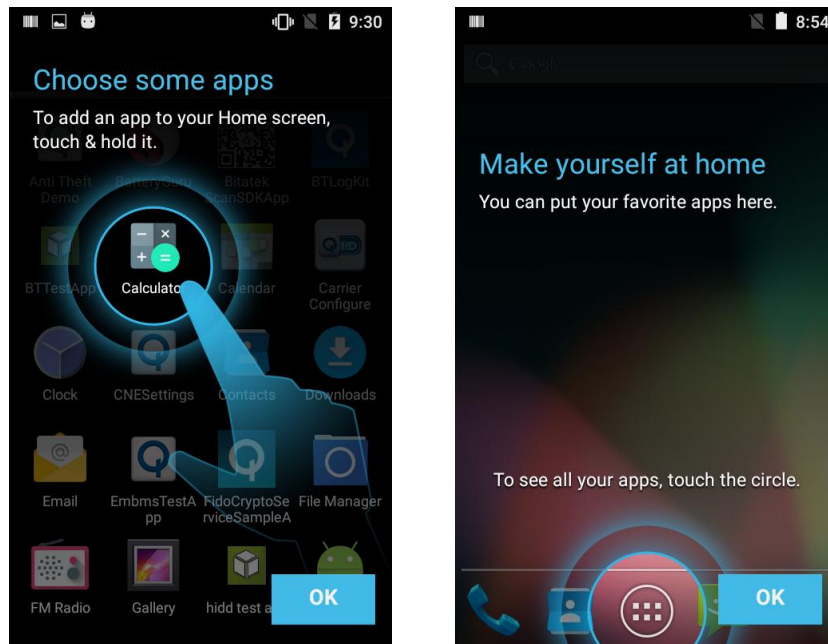

You can use a finger to slid left or right to change to another app screen. The system has five app screens include home screen. You can

management the APP icon on those app screens.

## 4.1. Barcode

### 4.1.1. Scanner Setting

Please tap  to go to Setting of Android

Select **Barcode** Item to go to set up barcode parameter.

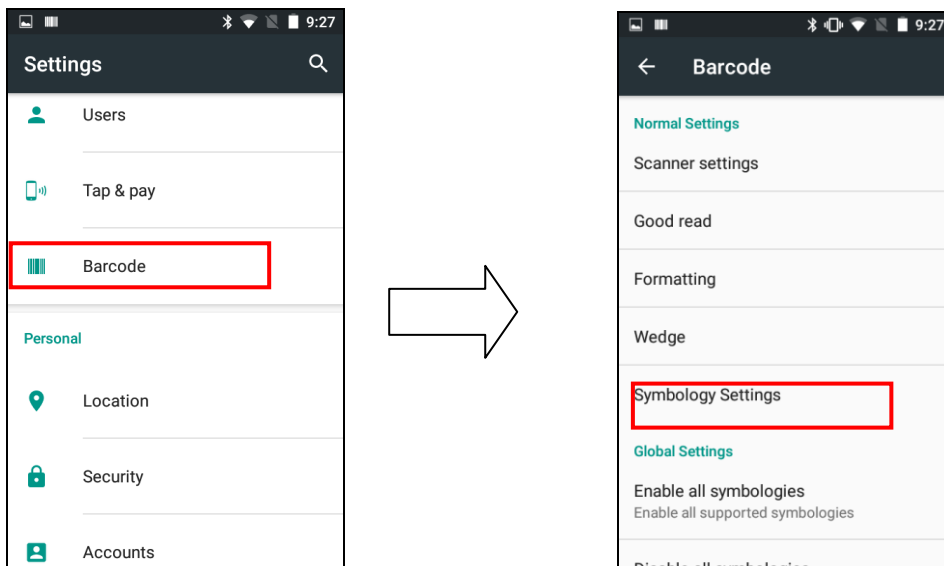

- Select **Symbology Settings** item that you can change the detail setting of all symbologies. Every setting of symbology is different.

The supported symbologies please reference **6.6 Barcode support information**.

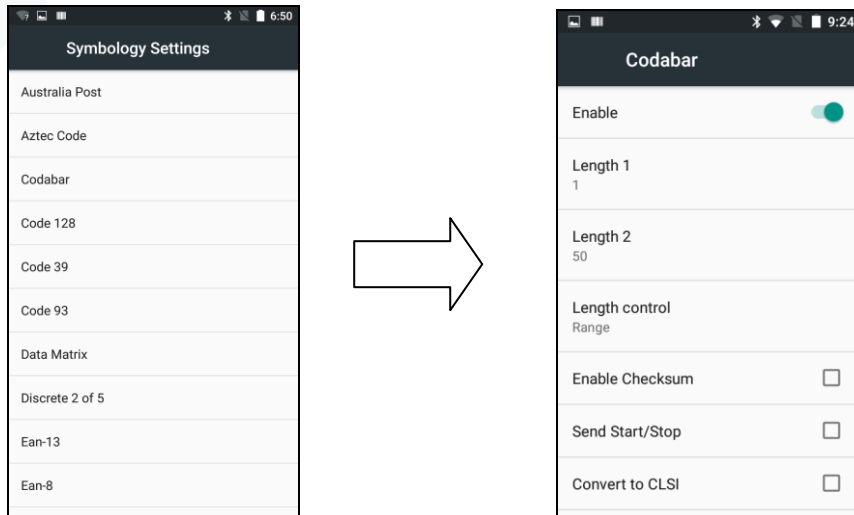

➤ Select **Wedge** item that enable intent wedge / keyboard wedge.

You can enable /disable intent wedge item, then to enable / disable the other settings of intent wedge.

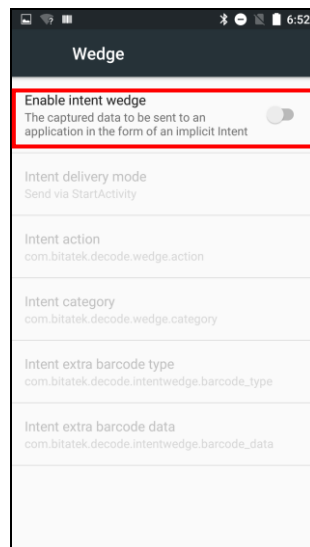

➤ Select **Formatting** item that you can set up prefix /suffix.

You can enable/disable code ID, or set up separator character of data format when you scan a barcode.



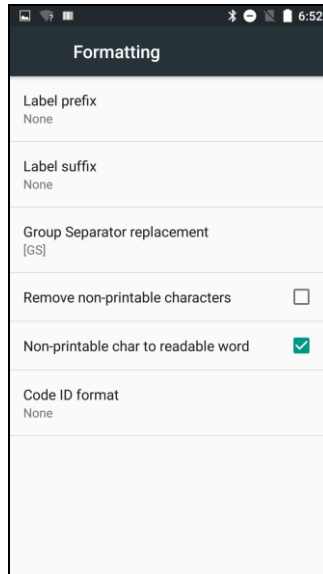

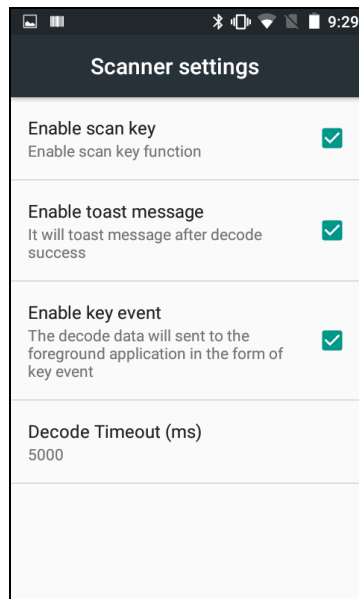

➤ Select **Scanner Settings** item that you can set up of Scanner engine behave.

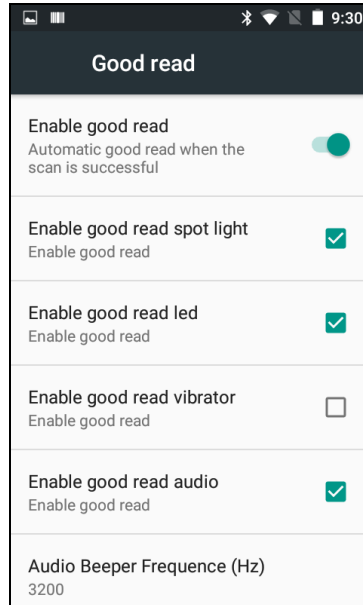

➤ Select **Good Read** item that you can enable / disable vibrator and other settings about Good read behavior.



### 4.1.2. Scan Demo

Please tap  to all application desktop, then tap  to enable Scan demo app.

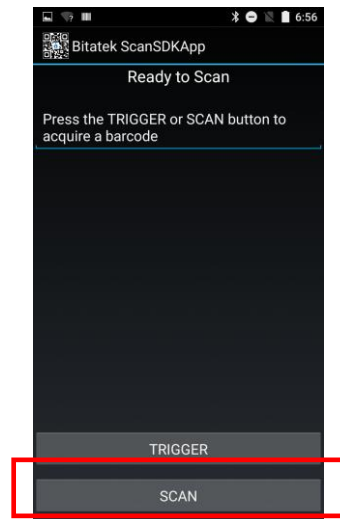
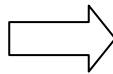
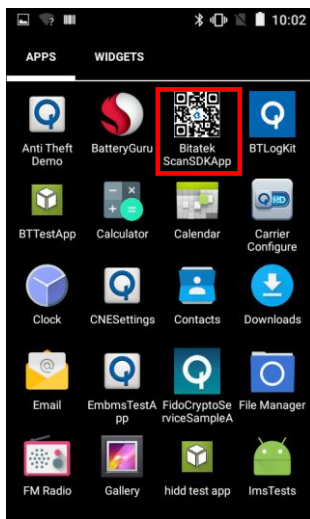

Press **Trigger** button or Scan Key and aim to a barcode, it will display the content of barcode after decode complete.

Press **Back** Button to quite this App.

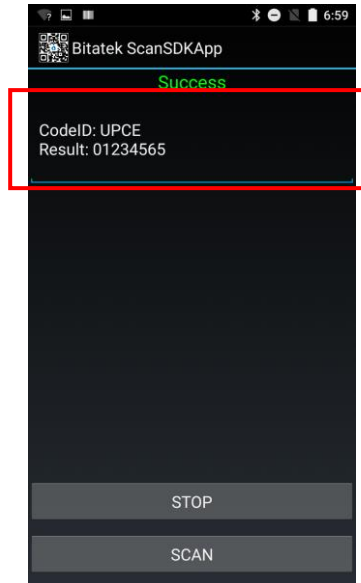

## 4.2. Wireless & Networks

Please tap  to go to Setting of Android

Select **Wireless & Networks** item.

You can enable/ disable Wi-Fi and Bluetooth settings.

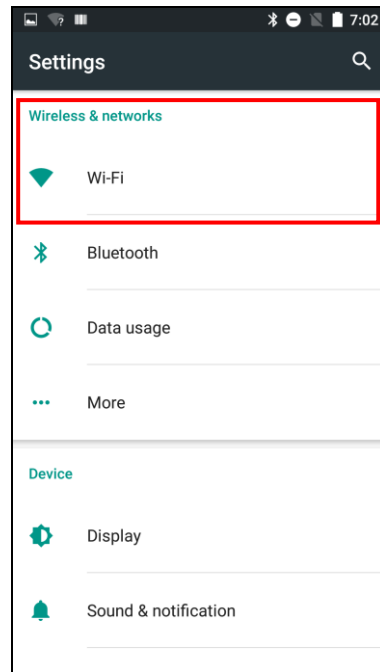

### 4.2.1. Wi-Fi

To use Wi-Fi, you need access to a wireless access point or “hotspot”.

- ✧ Tap the Wi-Fi tile to turn Wi-Fi on.
- ✧ Tap the Wi-Fi to see a list of detected wireless networks.
- ✧ Tap a Wi-Fi network you want to connect to.
- ✧ If you selected a secured network, enter the network key or password.
- ✧ Tap connect. You'll see the Wi-Fi icon in the status bar when connected.
- ✧ Tap and hold a Wi-Fi network that you already connected, then you can select **Forget network** to disconnect or select **modify**

**network** to reenter the network key or password.

If the wireless network that you want is not listed, tap + to manually add it.

When enabled, the Wi-Fi icon  is displayed on the status bar.

If you insert 3G SIM card into Frey Glider, the icon  is displayed on the status bar.

## 4.2.2. Bluetooth

- ✧ Tap the Bluetooth tile to turn Bluetooth on.
- ✧ Tap the Bluetooth to see a list of available devices.

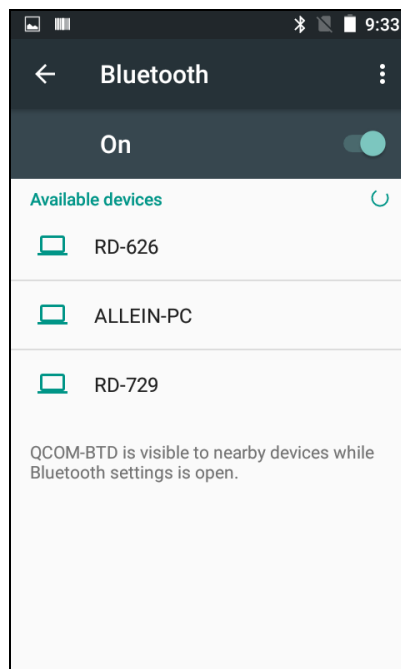

- ✧ If you don't see your headset listed, tap **SEARCH FOR DEVICE** to refresh the list.

- ✧ Tap the name of your headset in the Available Devices section. Frey Glider pairs with the headset and the headset connection status is displayed in the Paired Devices section.
- ✧ If prompted to enter a passcode, try 0000 or 1234, or consult the headset documentation to find the passcode.

When the Bluetooth headset is connected, you'll see in the status bar.

Normally, you can easily reconnect your headset by switching on Bluetooth on Frey Glider, and then turning on the headset.

However, you might have to connect manually if your headset has been used with another Bluetooth device..

When enabled, the Bluetooth icon  is displayed in the status bar.

### 4.2.3. Airplane mode

Two ways to enable / disable **Airplane**

One is select the **Airplane** Item when you press **Power** button until the message windows display. The other one is select more item of Android settings.

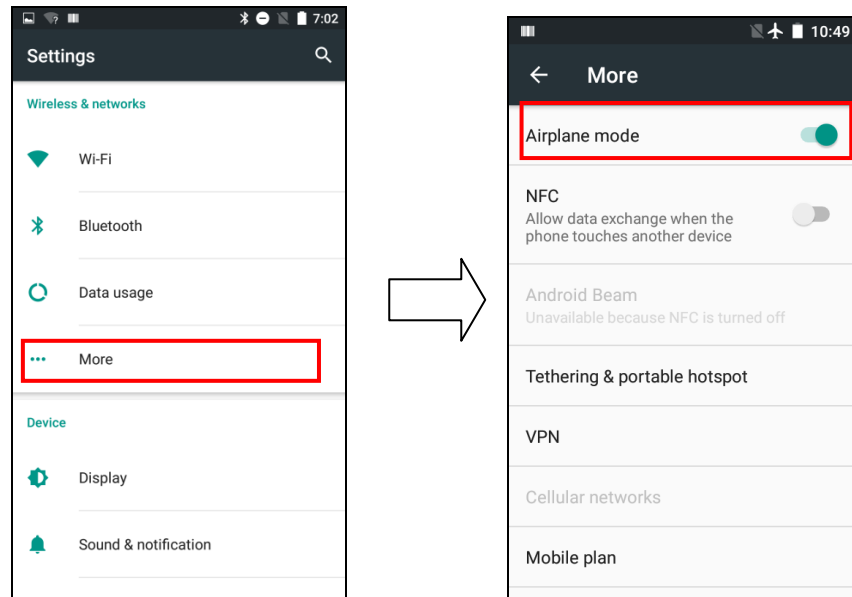

- When you enable **Airplane** (Flight) mode, all wireless radios on Frey Glider are turned off, including the call function, data services, Bluetooth, and Wi-Fi.

When you disable Airplane mode, the call function is turned back on and the previous state of Bluetooth and Wi-Fi is restored.

- You can manually turn Bluetooth and Wi-Fi back on after enabling Airplane mode.

Do any of the following to turn Airplane mode on or off:

- ✧ Press and hold **POWER** button, and then tap Airplane mode.
- ✧ With finger, swipe down from the status bar to open the Quick Settings panel. Tap the Airplane mode tile to turn airplane mode on or off.

When enabled, the Airplane mode icon  is displayed on the status bar.

#### 4.2.4. NFC

With built-in NFC (near field communication) on Frey Glider, you can share content to another NFC capable mobile device in an instant.

Beam webpages, photos, contact information, and more by holding Frey Glider and the other device back to back.

Turning NFC on or off

- Go to Settings, and then under **Wireless & networks**, tap **More... .**
- Tap **NFC** check box to Enable / disable NFC function
- If enable / disable NFC check box, it will also enable / disable **Android Beam** too.



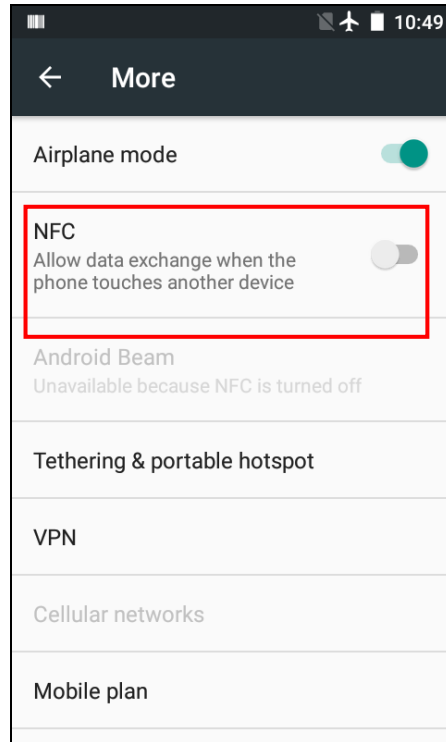

1. Make sure that both devices are unlocked and have NFC turned on.  
If the other device has an Android Beam option, make sure it is also turned on.
2. Make sure that the NFC area (shaded part) of Frey Glider and the other phone's NFC area are close to one another. Experiment by slightly moving the phones until a connection is made.
3. Tap the screen.

The shared content appears on the other screen. For some items that you've shared (such as contact information), additional instructions on how to save the item will appear on the receiving device.

### 4.2.5. Set Fey Glider as a portable hotspot

Share your data connection with other devices by turning Frey Glider into a Wi-Fi hotspot.

Please tap  to go to Setting of Android

1. Open the Settings app
2. Under **Wireless & Networks**, tap **More**.
3. Tap **Tethering & portable hotspot**
4. Tap **portable Wi-Fi hotspot**

The first time you want turn on the Wi-Fi hotspot, you'll need to set it up

5. Enter a hotspot name or use the default.
6. Enter a password or use the default.
7. Tap the Portable Wi-Fi Hotspot check box to enable switch to turn it on.

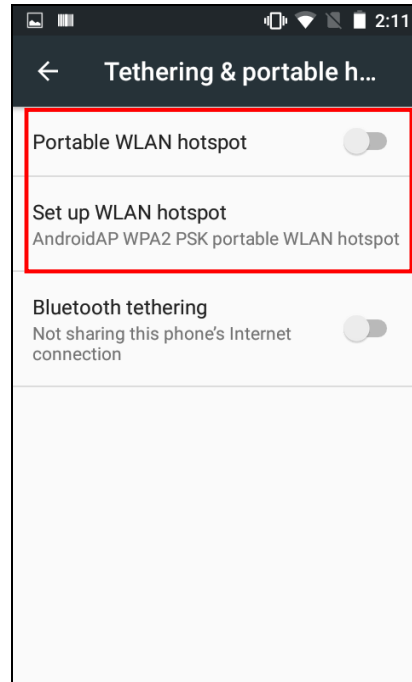

When enabled, the Hotspot icon  is displayed in the left side of status bar.

## 4.2.6. Sharing Frey Glider internet connect by USB

If internet connection not available for your computer, you can use the data connection of Frey Glider to connect to the Internet.

Please tap  to go to Setting of Android

1. Open the Settings app
2. Under **Wireless & Networks**, tap **More**.
3. Tap **USB tethering** check box

4. Connect Frey Glider to your computer using the provided USB cable.

### 4.2.7. Sharing Frey Glider internet connect by Bluetooth

Please tap  to go to Setting of Android

1. Open the Settings app
2. Under **Wireless & Networks**, tap **More**.
3. Tap **Bluetooth tethering** check box

Connect Frey Glider to your computer using Bluetooth.

## 4.3. Backup & Reset

Please tap  to go to Setting of Android,

You can reset to factory default when you select **Factory data reset** item, it will erase all include enterprise folder

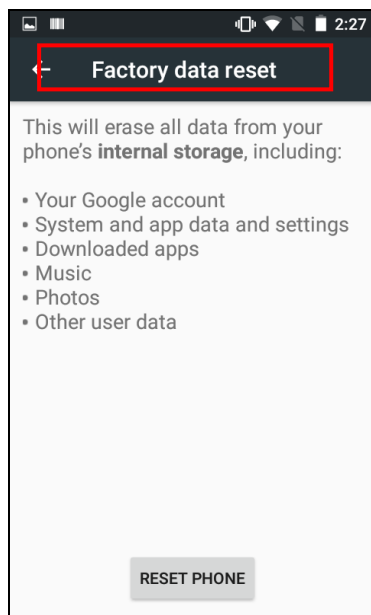
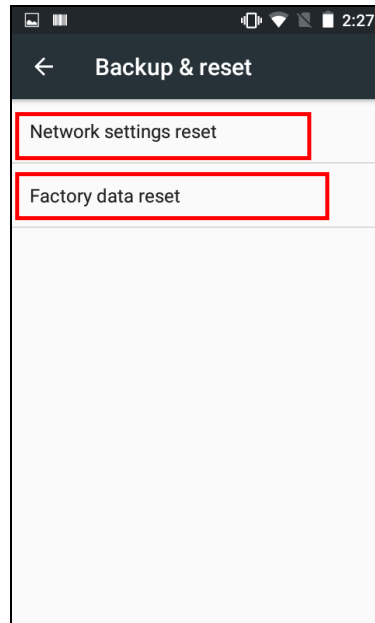

Factory Data Reset

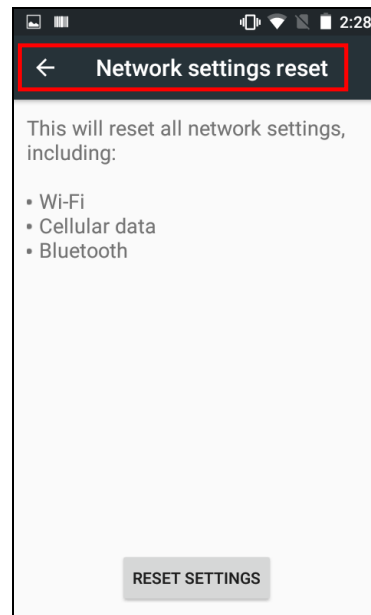

Network Setting Reset

You can reset to factory default when you select **Network Setting reset** item, it will erase all RF data.

## 4.4. Phone

Please tap  to start Phone App

You can press  then dial a number directly, or use Smart dial to quickly place a call. Smart dial searches and calls a stored/synced contact or a number from your call history.

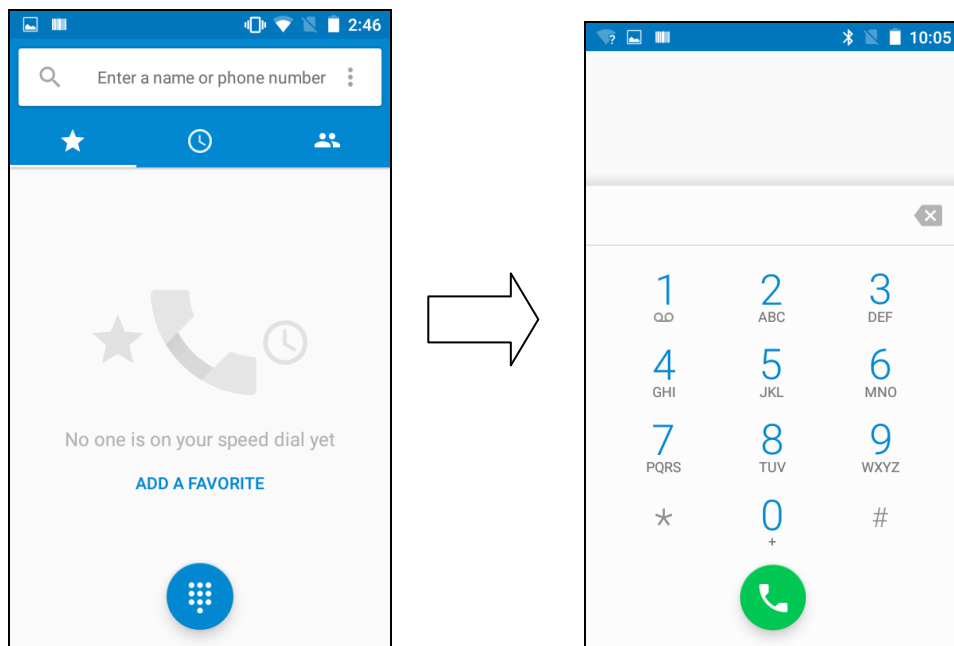

You'll see the missed call icon  in the status bar when you miss a phone come in.

## 4.5. People



The People app lists all contacts you've stored on Frey Glider and

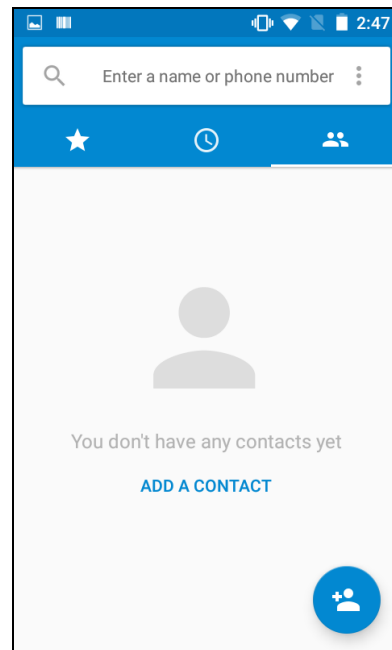

from online accounts you're logged in to. Use the People app to easily manage communications with people that matter to you.

Please tap  to start People App



please tap  to Add new People. Then input more information.  
Then tap  to save.

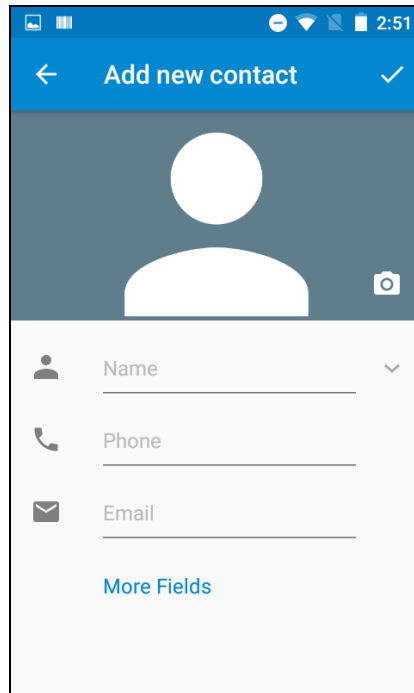



## 4.6. Message

There is a limit on the number of characters for a single text message, the default value is 500.

Please tap  to start Message App

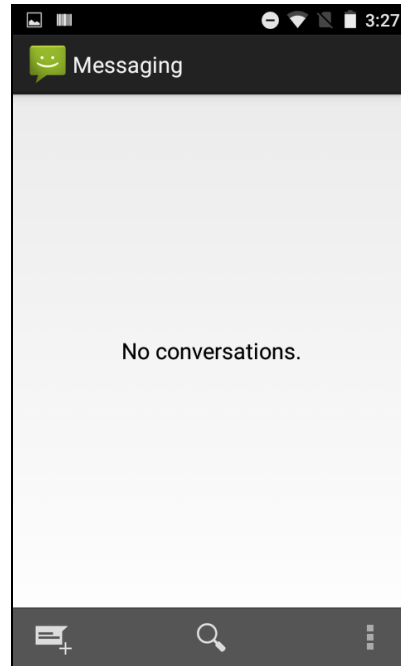



Please tap  to Add new Message, then input the phone number of the people that you want send to. And write the content of message.

And press  to start send.

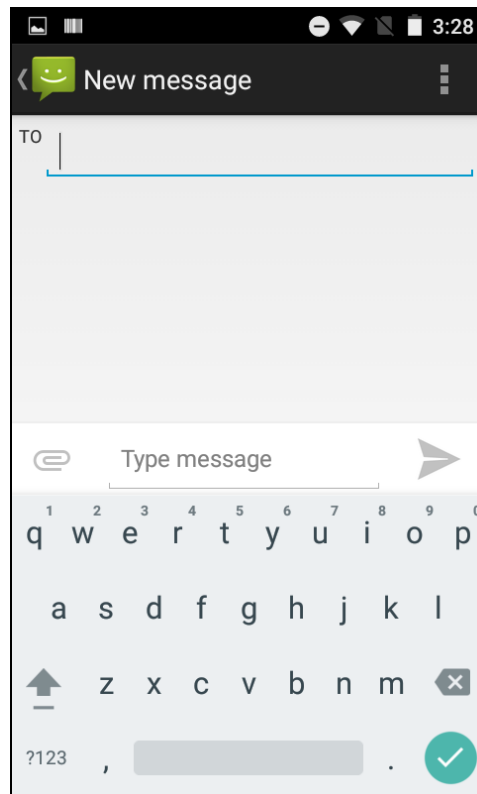

Press  Button and select Settings item to enable message setting.

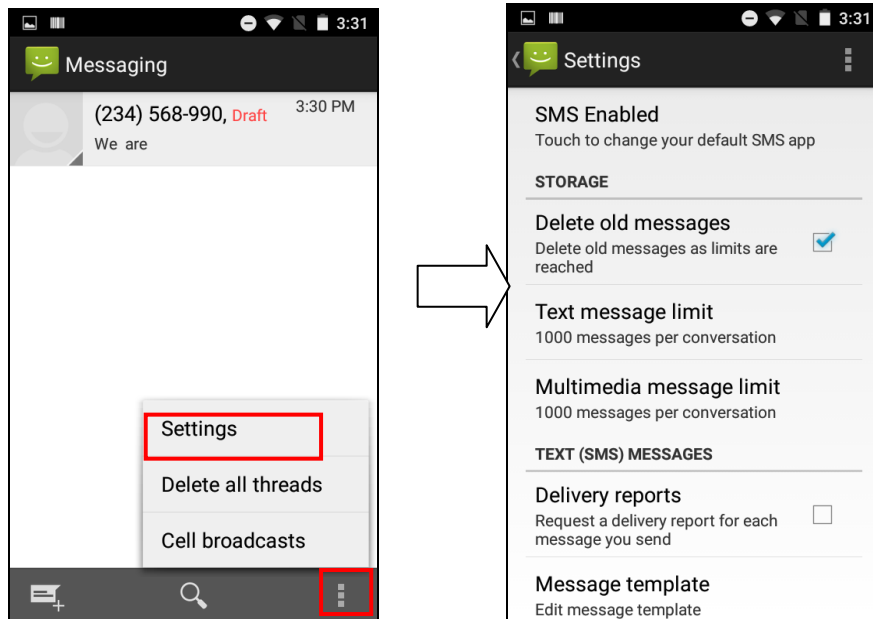

## 4.7. Email

The Mail app is where you read, send, and organize email messages from one or more email accounts that you've set up on Frey Glider.

Before use Email, you must set the mail account first.

Please make sure the WiFi is Ok, when you set the mail account.

Please tap  to start Email app

If you use Mail app first time, please contact your MIS people to help to set the Mail account if you need.

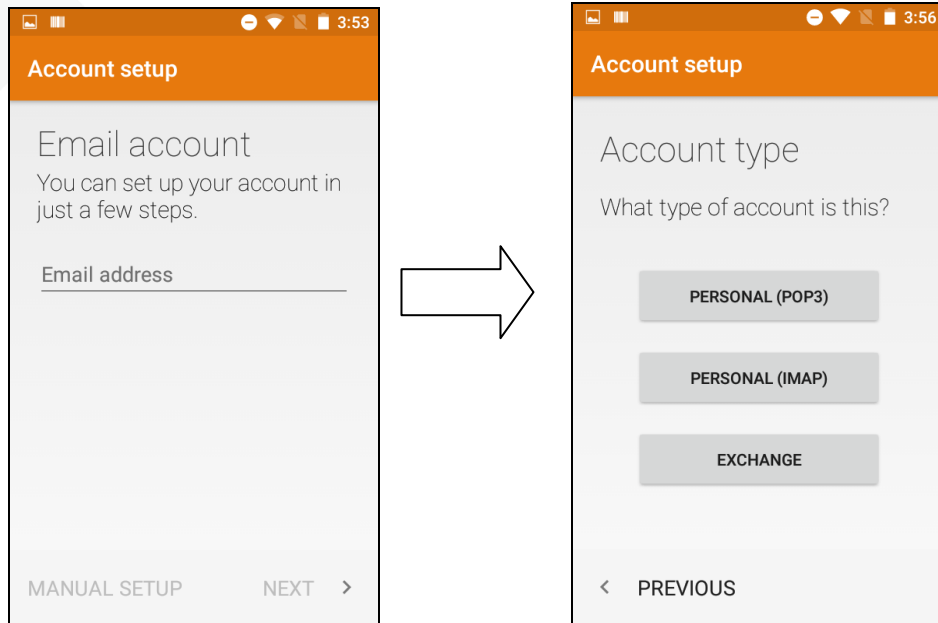

After set up your mail account complete

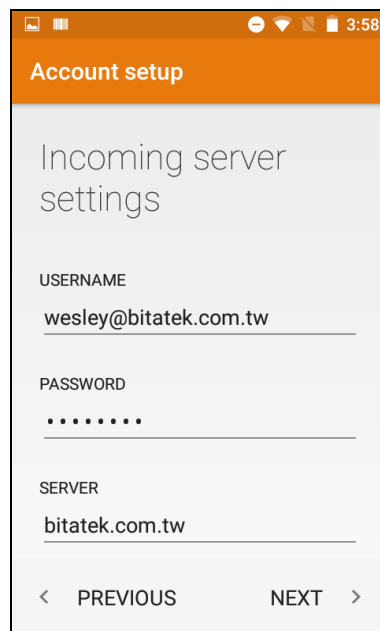

## 4.8. Camera

Please tap  to start Camera App, press  to take a picture.

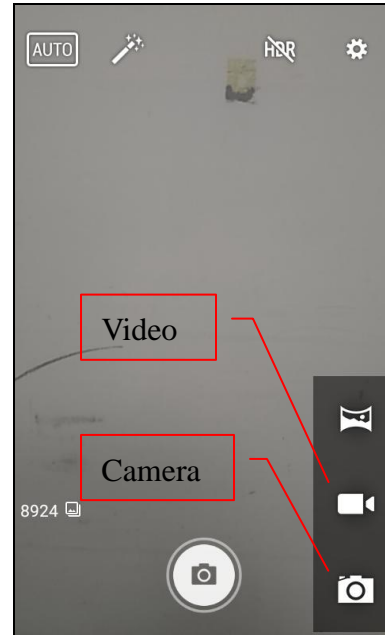

## Camera Settings

Press  to do advance setting.

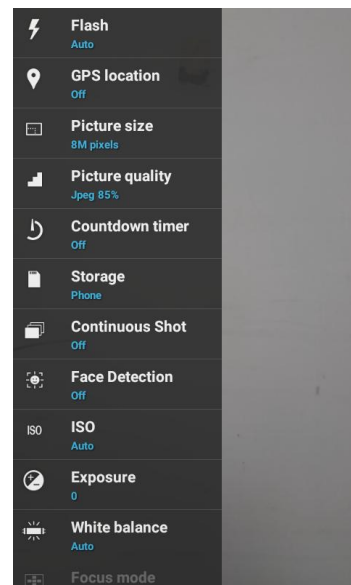
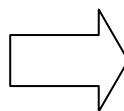

Press  to do mode setting



Press  to do effects setting



## Video Settings

Press  to do advance setting.

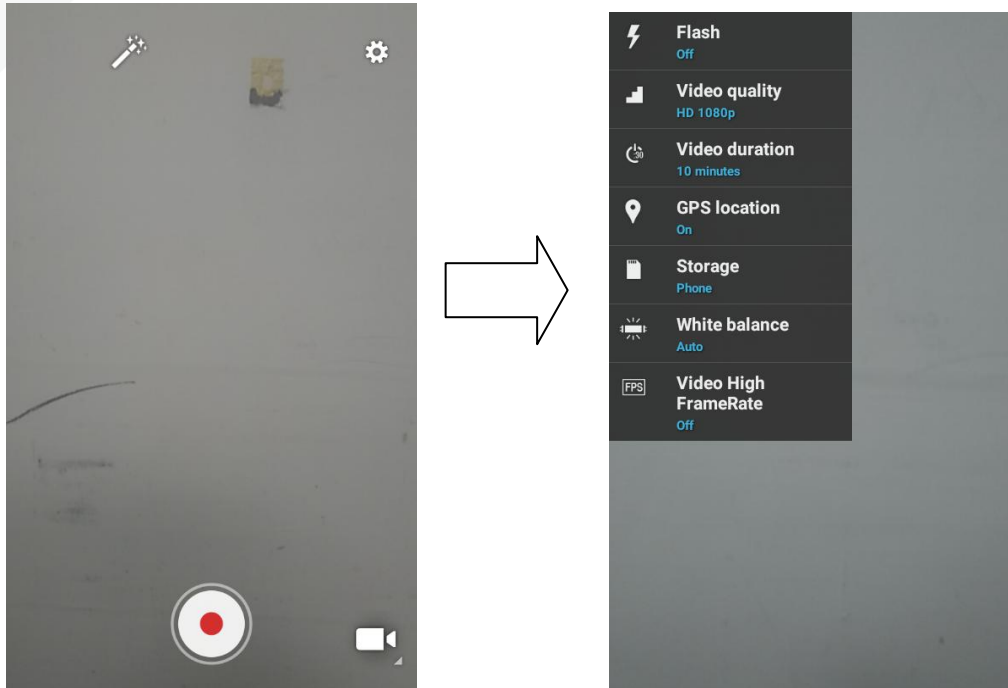

## 4.9. Calendar

Please tap  to start Calendar App

Use the Calendar app to view your events, meetings, and appointments. If you've signed into your online Google mail accounts, related events will also appear in Calendar.

Please tap ▼, and then choose a calendar view display mode.

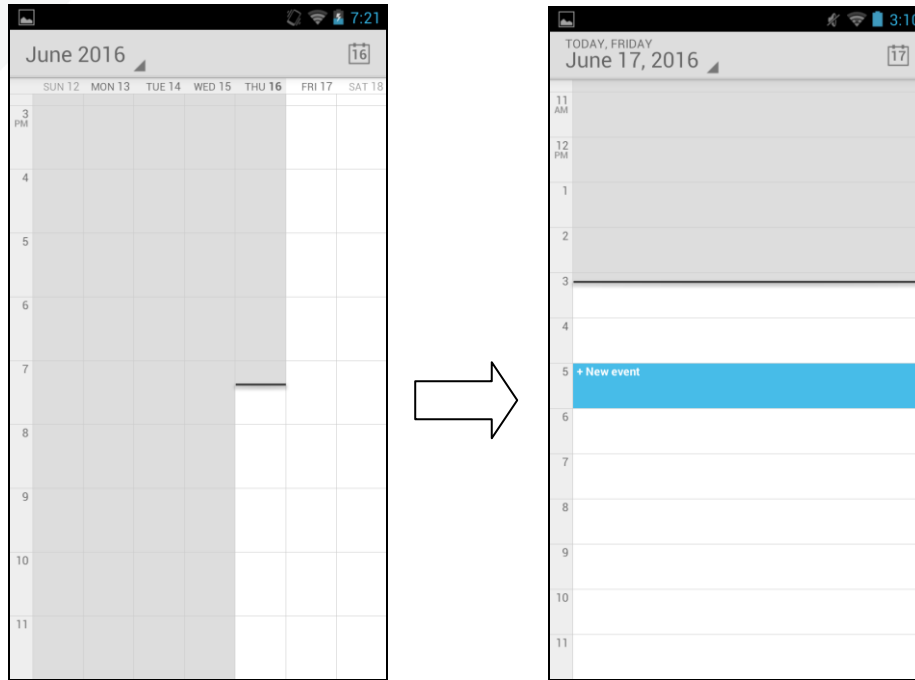

## 4.10. Calculator



Please tap  to start Calculator App

The Calculator App have two panels.

You can press **Menu** Button or slid screen to right /left to change panel between Basic and advance panel.

Basic Panel as follow

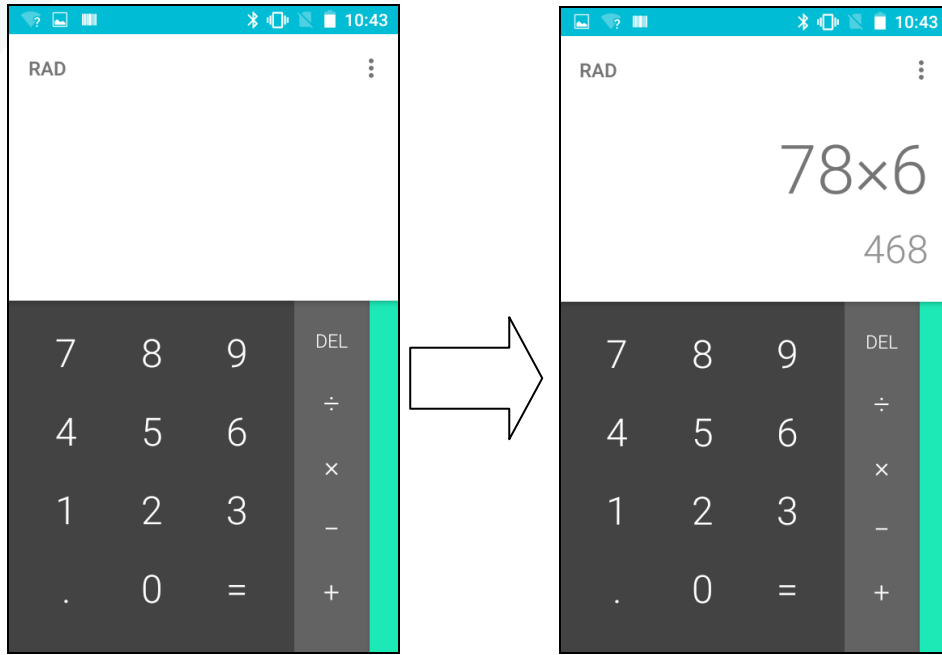

Press and slide to left to Advance Panel

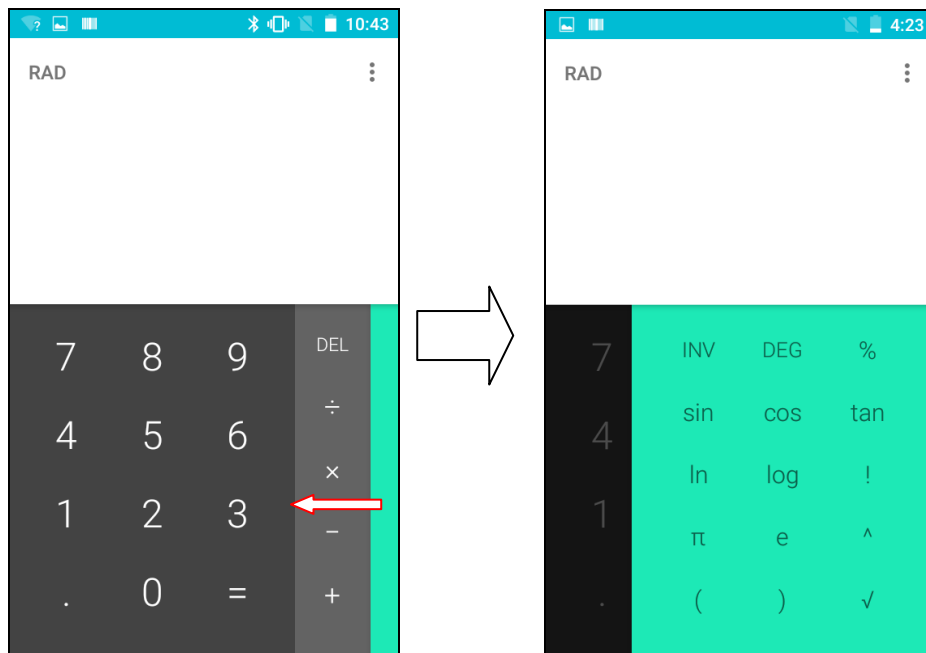



## 4.11. File Manager

Please tap  to start File Manager App. You can open /copy/move/delete file or folder.

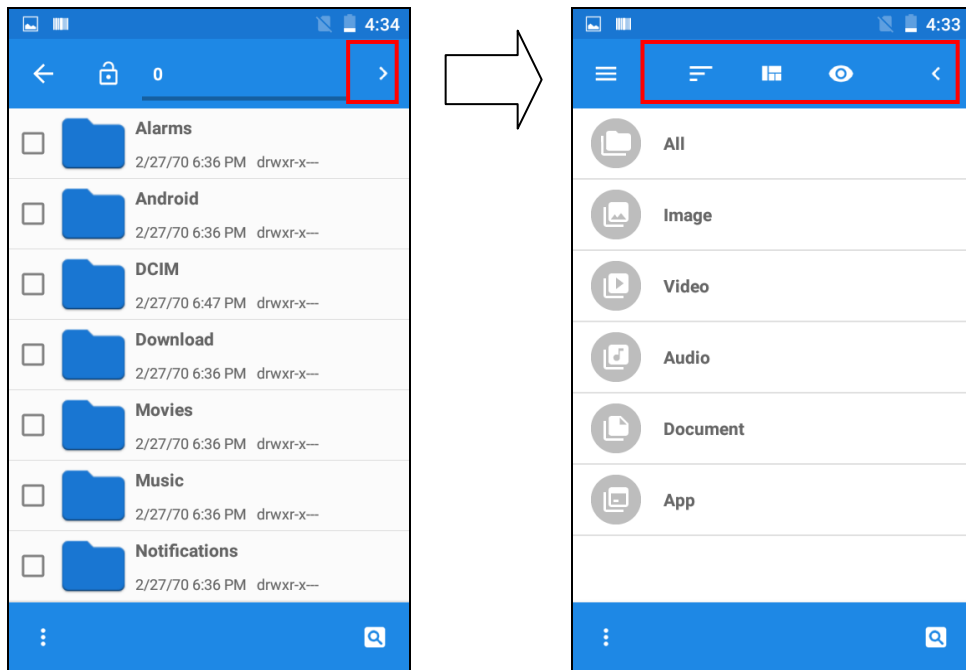

Press the fold name than you can do another actions.

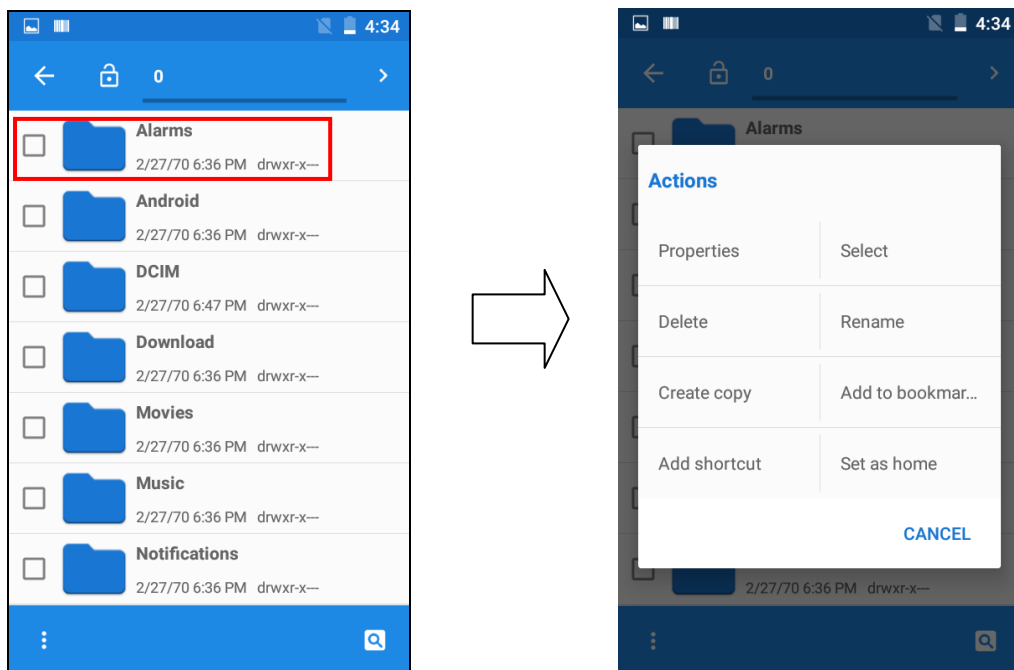

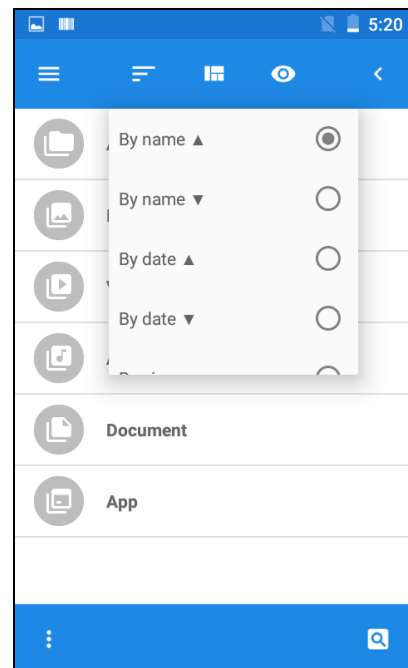
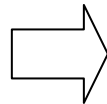
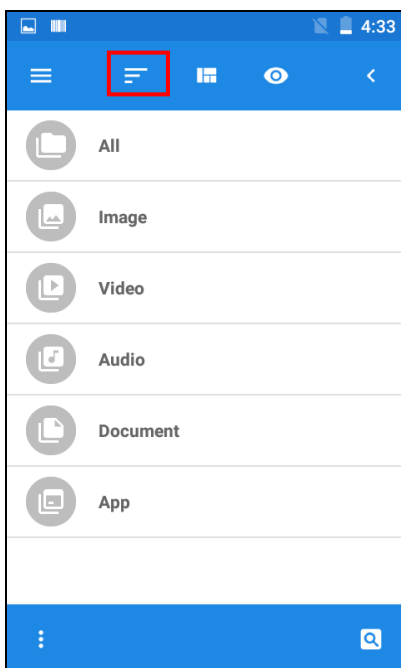
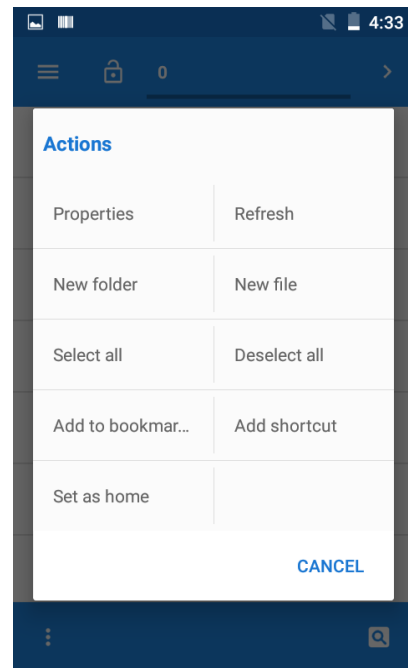
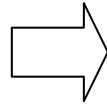
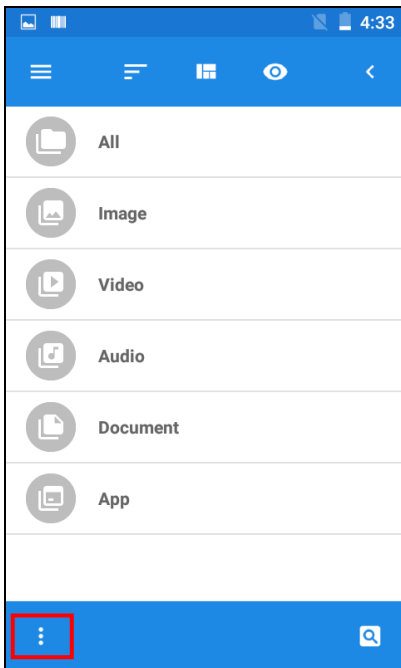

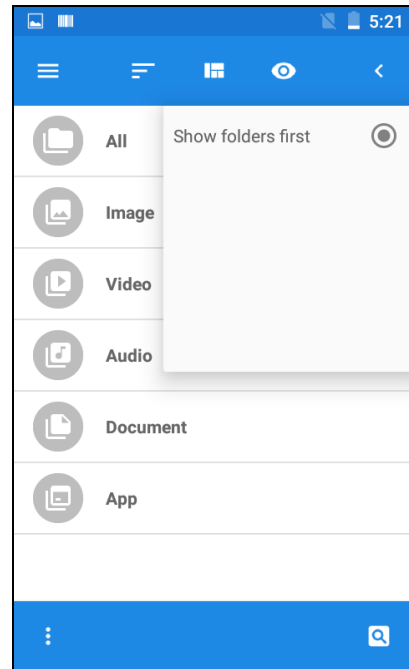
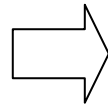
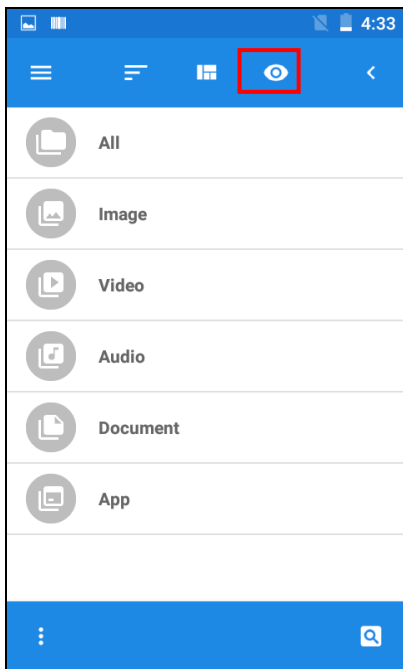
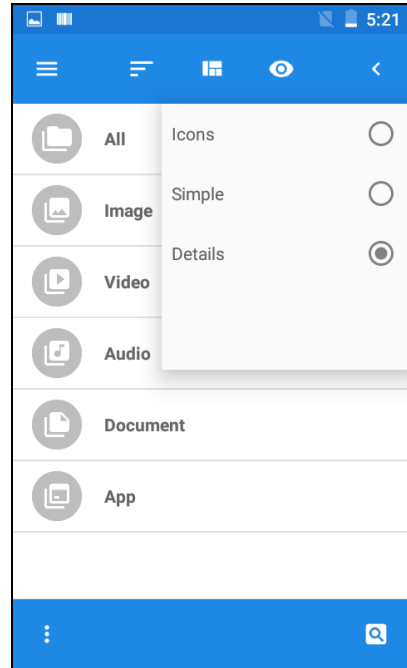
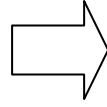
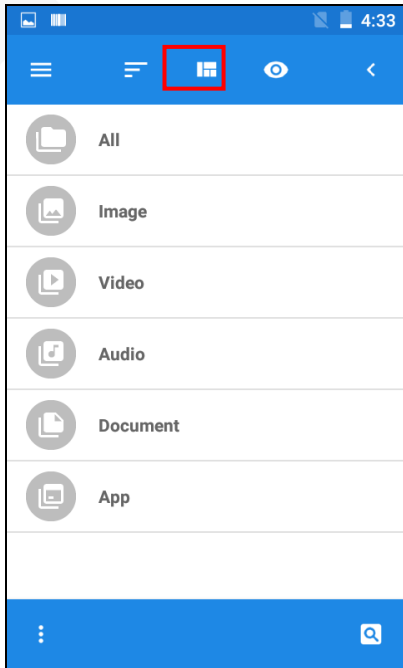

## 4.12. Widgets/APPS

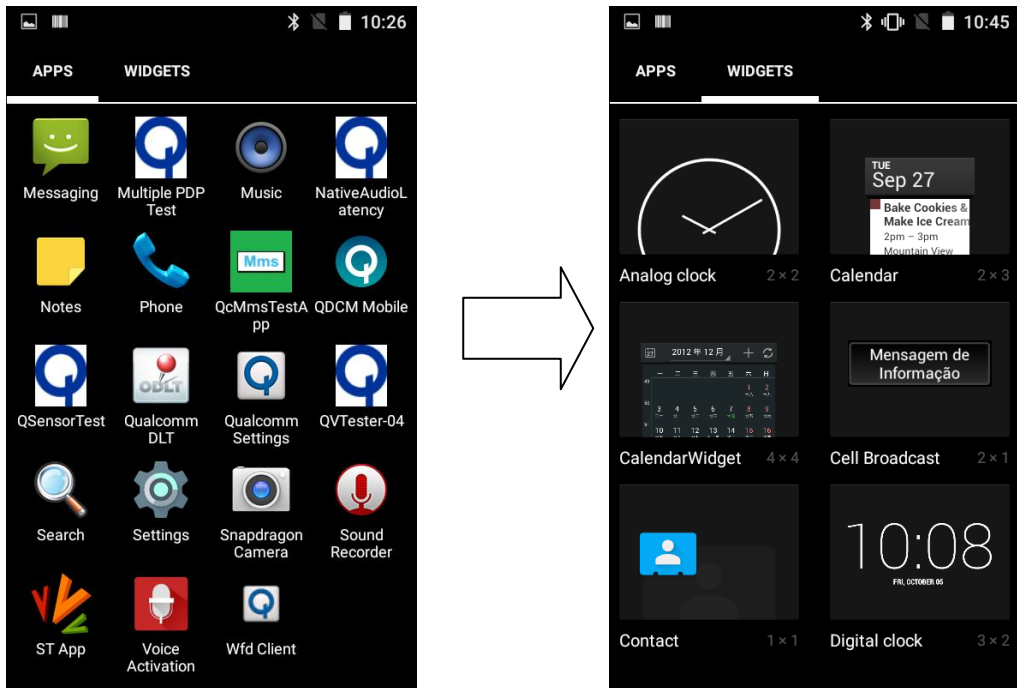

You can press some Widget tools and add the widget tools to the home Screen or other application screen.

## Charpt 5. Appendix

---

### 5.1. Regulatory

This device has been tested and found to comply with the limits for a Class B digital device, pursuant to part 15 of the FCC rules. These limits are designed to provide reasonable protection against harmful interference in a residential installation. This equipment generates, uses and can radiate radio frequency energy and, if not installed and used in accordance with the instructions, may cause harmful interference with radio communications. However, there is no guarantee that interference will not occur in a particular installation.

### 5.2. Battery Notes

It is important to consider temperature when the battery pack is charging. Charging is most efficient at normal room temperature or in a slightly cooler environment. It is essential that batteries are charged within the stated range of 0°C to 40°C. Charging batteries outside of the specified range could damage the batteries and shorten their life cycle.

1. To guarantee optimal performance, it is recommended that rechargeable batteries be replaced every year, or after 500 charging cycles are completed. It is normal for the battery to balloon or expand after one year or 500 cycles. Although it does not cause damage, it cannot be used again and must be disposed of according to the location's safe battery disposal procedures.
2. If a battery performance decreases more than 20%, the battery is at the end of its life cycle. Stop use and ensure the battery is disposed of properly.

## 5.3. Storage and safety notice

Although charged batteries may be left unused for several months, their capacity may be depleted due to build up of internal resistance. If this happens, they will require recharging prior to use. Batteries may be stored at temperatures between  $-20^{\circ}\text{C}$  to  $60^{\circ}\text{C}$ , however they may deplete more rapidly at higher temperatures. It is recommended to store batteries at room temperature.

## 5.4. Product Operation and Storage Notice

The Bitatek product has applicable operation and storage temperature conditions. Please follow the limitation of suggested temperature conditions to avoid failure, damage or malfunction.

## 5.5. Adapter Notes

1. Please do not leave the power adapter in the socket when it is not connected to your bitatek product for charging.
2. Please remove the power adapter when the battery is fully recharged.
3. The bundled power adapter that comes with your Bitatek product is not meant to be used outdoors. An adapter exposed to water or rain, or a very humid environment can cause damage to both the adapter and the product.
4. Please only use the bundled power adapter or same specification of adapter to charge your Bitatek product. Using the wrong power adapter can damage your Bitatek product.

## 5.6. Support Barcode information

The following bar code types are supported and can be individually enabled or disabled:

1D Symbologies	2D Symbologies
UPC/EAN	PDF417
ISSN EAN	MicroPDF417
Code 128	Data Matrix
Code 39	Aztec
Code 32	Maxicode
Code 93	QR Code
Interleaved 2 of 5	MicroQR
Discrete 2 of 5	
Codabar	
MSI	
Matrix 2 of 5	
GS1 DataBar	
US Postnet	
US Planet	
UK Postal	
Japan Postal	
Australian Postal	
Netherlands KIX Code	
USPS 4CB/One Code/Intelligent Mail	